

C:\USERS\JOHN\ONEDRIVE - WASHINGTON COUNTY OPS ENGINEERING PROJECTS - DOCUMENTS\PROJECT DEVELOPMENT\100821 - SCHMELTZER RD CULVERT REPLACEMENT PROJECT DESIGN\PLANS\SCHMELTZER-BASET11425.DWG 12/2/2025 3:14 PM john



PLANS FOR PROPOSED PROJECT GRADING, DRAINAGE, & STRUCTURE

SCHMELTZER ROAD CULVERT REPLACEMENT CULVERT #2309

INDEX OF SHEETS		
NO.	TITLE	DESCRIPTION
1	G01	TITLE SHEET
2	TS01	TYPICAL SECTIONS
3	EC01	EROSION CONTROL PLAN
4	TC01	TRAFFIC CONTROL PLAN
5	C01	STREET PLAN & PROFILE
6	C02	CULVERT PLAN & PROFILE
7	C03	DETAILS

FILE NO.	TAXLOT	ADDRESS
1	2N2270001300	NO ADDRESS
2	2S2270000702	21430 SW SCHMELTZER RD.



ODOT DRAWINGS HEREIN MADE A PART OF THESE PLANS.

RD300 - TRENCH BACKFILL, BEDDING, PIPE ZONE AND MULTIPLE INSTALLATIONS

CLEAN WATER SERVICES DETAILS HEREIN MADE PART OF THESE PLANS

- 805 - MATTING SLOPE INSTALLATION
- 830 - SURFACE ROUGHENING CAT TRACKING
- 835 - SURFACE ROUGHENING STAIR STEPPING/GROOVING SLOPES
- 875 - SEDIMENT FENCE
- 880 - WATTLES
- 945 - STANDARD EROSION CONTROL NOTES FOR SITES LESS THAN 1 ACRE

GENERAL NOTES:

1. OBTAIN ALL NECESSARY UTILITY LOCATES PRIOR TO EXCAVATION AND COORDINATE ANY LOGISTICAL REQUIREMENTS WITH THE UTILITY COMPANIES
2. ANY ITEM DAMAGED DURING CONSTRUCTION TO BE REPLACED OR REPAIRED, IN KIND
3. ILLUSTRATED INFORMATION IS BASED ON DATA ACQUIRED THROUGH FIELD MEASUREMENTS, TOPOGRAPHIC SURVEY AND AERIAL PHOTOGRAPHY. UTILITY LOCATIONS SHOWN ON THESE PLANS ARE FOR GRAPHICAL PURPOSES ONLY.
4. EROSION CONTROL MEASURES SHOWN ON THESE PLAN ARE THE MINIMUM NECESSARY TO COMPLETE THE WORK. ADDITIONAL EROSION CONTROL MEASURES MAY BE NECESSARY TO PERFORM THE WORK IN CONFORMANCE WITH ALL APPLICABLE LOCAL, STATE AND FEDERAL EROSION CONTROL REGULATIONS AS CONDITIONS CHANGE.
5. DETERMINING ALL TRAFFIC CONTROL MATERIALS AND METHODS FOR EACH PHASE OF WORK. TRAFFIC CONTROL MUST BE IN CONFORMANCE WITH ALL APPLICABLE TRAFFIC CONTROL REGULATIONS AND STANDARDS.
6. THESE DRAWINGS ARE PROVIDED AS A SCHEMATIC ONLY TO SHOW THE GENERAL LAYOUT OF THE PROPOSED WORK. ACTUAL LIMITS WILL BE MARKED IN THE FIELD. NO REPRESENTATION IS MADE AS TO THE ACCURACY OF THE INFORMATION SHOWN.

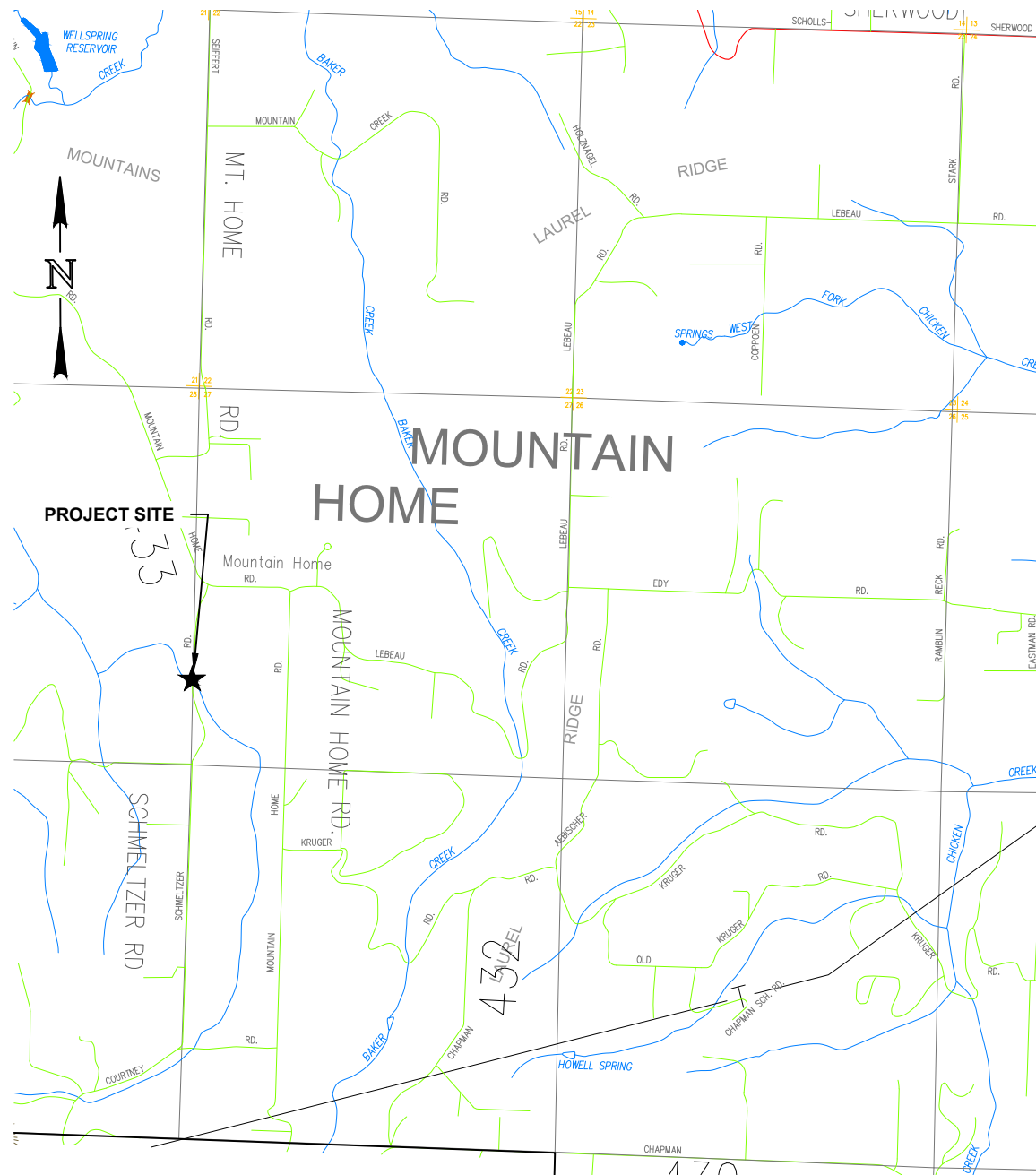

PROJECT MAP
NOT TO SCALE

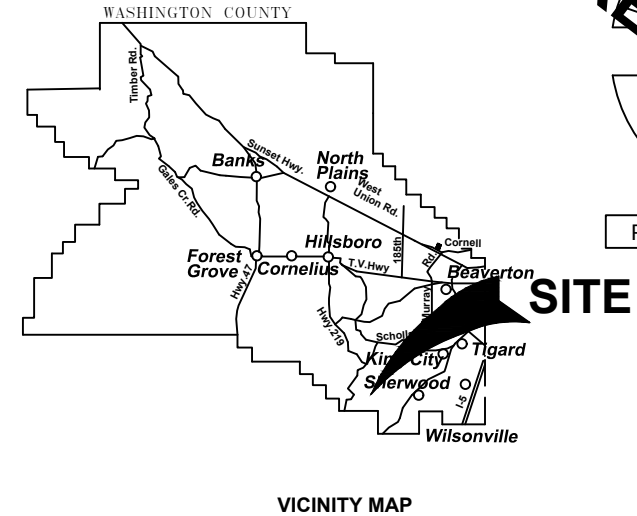

ATTENTION:
OREGON LAW REQUIRES YOU TO FOLLOW RULES ADOPTED BY THE OREGON UTILITY NOTIFICATION CENTER. THOSE RULES ARE SET FORTH IN OAR 952-001-0010 THROUGH OAR 952-001-0090. YOU MAY OBTAIN COPIES OF THE RULES FROM THE CENTER. CALL 811 TO CONTACT NOTIFICATION CENTER

LEGEND

- | General | |
|-----------------|---------------------------------|
| | Alignment |
| | Edge of Gravel |
| | Fill |
| | Cut |
| | Ditch |
| | Culvert |
| | Fence |
| | Guardrail |
| | Right-of-Way |
| | Proposed Right-of-Way |
| | Temporary Construction Easement |
| | Property Line |
| | Overhead Utilities |
| | Edge of Gravel |
| Utilities/Boxes | |
| | Control Point |
| | Mailbox |
| | Guy Wire |
| | Utility Pole |

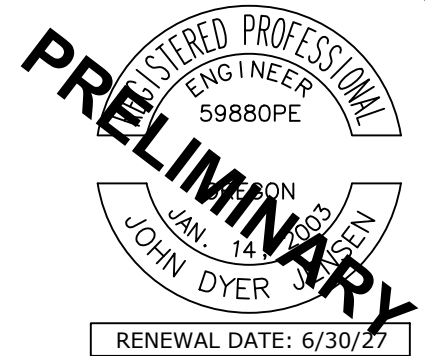

DESIGNED BY: J JENSEN
DRAWN BY: J JENSEN
CHECKED BY: A CLODFELTER

SCHMELTZER ROAD
CULVERT #2309
WASHINGTON COUNTY

TITLE SHEET

PROJECT NUMBER
100821
SHEET NO.
1 OF 7
G01

C:\USERS\JOHN\ONEDRIVE - WASHINGTON COUNTY OPS ENGINEERING PROJECTS - DOCUMENTS\PROJECT DEVELOPMENT\100821 - SCHMELTZER RD CULVERT REPLACEMENT PROJECT\DESIGN\PLANS\SCHMELTZER-BASE\11425.DWG 12/2/2025 3:15 PM john

REGISTERED PROFESSIONAL ENGINEER
59880PE

PRELIMINARY

JAN. 14, 2003
JOHN DYER JENSEN

RENEWAL DATE: 6/30/27

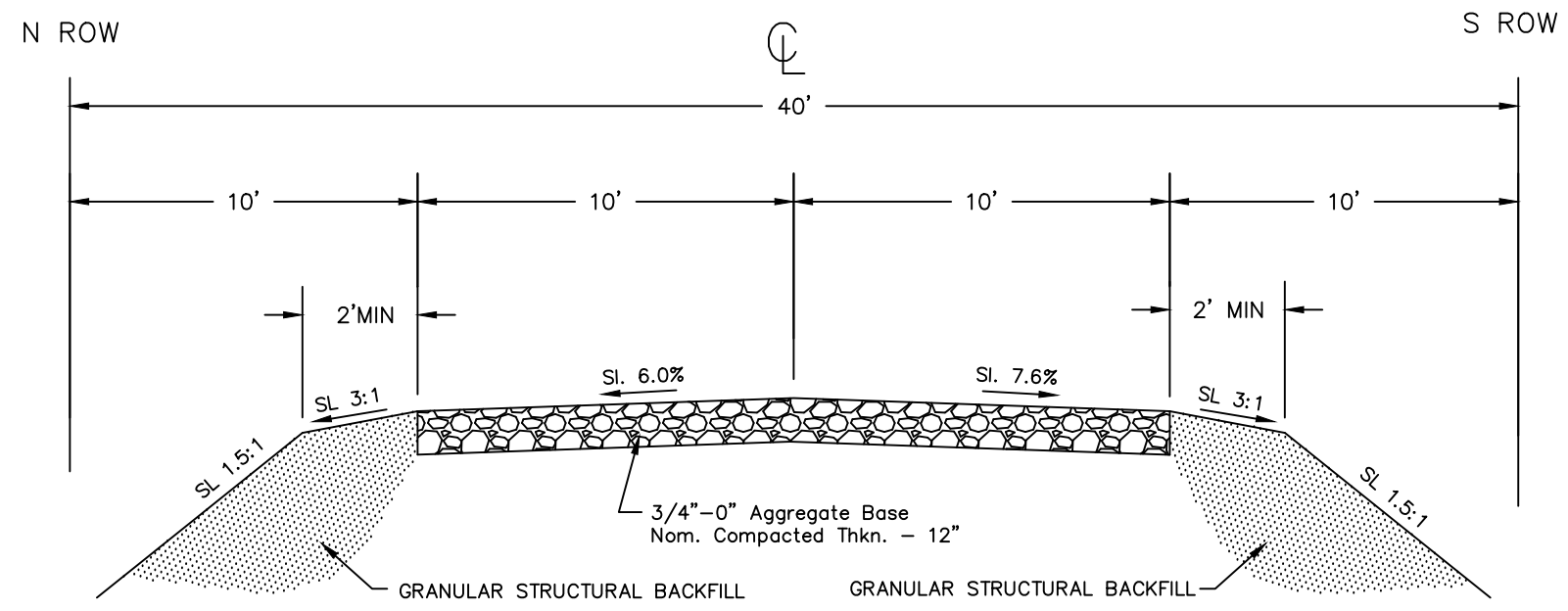

SCHMELTZER ROAD
Sta. 11+79 to 12+49

DEPARTMENT OF
LAND USE &
TRANSPORTATION
OPERATIONS

WASHINGTON COUNTY
OREGON





DESIGNED BY: J JENSEN DRAWN BY: J JENSEN CHECKED BY: A CLODFELTER	NO. REVISIONS <table border="1" style="width: 100%; height: 40px;"> <tr><td> </td><td> </td></tr> <tr><td> </td><td> </td></tr> </table>				

SCHMELTZER ROAD CULVERT #2309 WASHINGTON COUNTY	TYPICAL SECTIONS
---	------------------

PROJECT NUMBER 100821
SHEET NO. 2 OF 7 TS01

C:\USERS\JOHN\ONEDRIVE - WASHINGTON COUNTY OPS ENGINEERING PROJECTS - DOCUMENTS\PROJECT DEVELOPMENT\100821 - SCHMELTZER RD CULVERT REPLACEMENT PROJECT\DESIGN\PLANS\SCHMELTZER-BASET11425.DWG 12/2/2025 3:15 PM John

EROSION CONTROL LEGEND

- EROSION CONTROL MATTING 
- STRAW WATTLES 
- FILL LIMITS 
- TREE TO BE REMOVED 

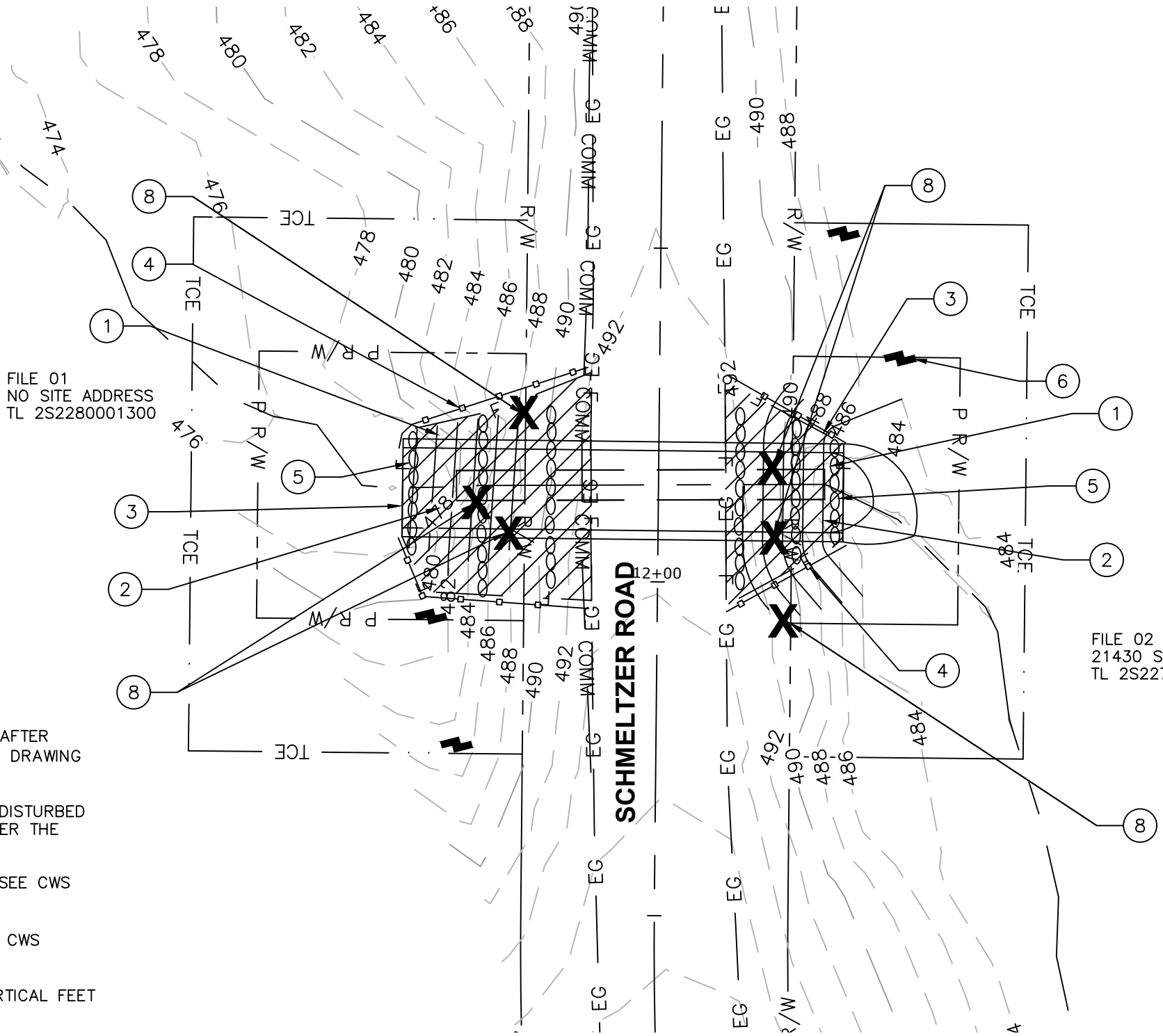

FILE 01
NO SITE ADDRESS
TL 2S2280001300

FILE 02
21430 SW SCHMELTZER RD.
TL 2S2270000702

SCHMELTZER ROAD

EROSION CONTROL NOTES

- 1 ROUGHEN SURFACE OF SLOPE AFTER GRADING (SEE CWS STANDARD DRAWING 830).
- 2 PRIOR TO MATTING, SEED ALL DISTURBED AREAS USING NATIVE GRASS PER THE STANDARD SPECIFICATONS.
- 3 MATTING SLOPE INSTALLATION SEE CWS STANDARD DRAWING 805)
- 4 INSTALL SEDIMENT FENCE (SEE CWS STANDARD DRAWING 875)
- 5 INSTALL WATTLES EVERY 8 VERTICAL FEET ACROSS SLOPE.
- 6 INSTALL BIOBAGS IN DITCH 25- FEET O.C.
- 7 REFER TO CWS STANDARD DRAWING 945 FOR EROSION CONTROL NOTES FOR SITES LESS THAN 1 ACRE.
- 8 6 TREES TO BE REMOVED (TYP.) PRESERVE AND PROTECT ALL OTHER TREES NOT MARKED FOR REMOVAL.

REGISTERED PROFESSIONAL
ENGINEER
59880PE

PRELIMINARY

JAN. 14, 2023
JOHN DYER JENSEN

RENEWAL DATE: 6/30/27

DEPARTMENT OF
LAND USE &
TRANSPORTATION
OPERATIONS



DESIGNED BY: J JENSEN	
DRAWN BY: J JENSEN	
CHECKED BY: A CLODFELTER	
NO. REVISIONS	

SCHMELTZER ROAD
CULVERT #2309
WASHINGTON COUNTY

EROSION CONTROL PLAN

PROJECT NUMBER 100821
SHEET NO. 3 OF 7
EC01

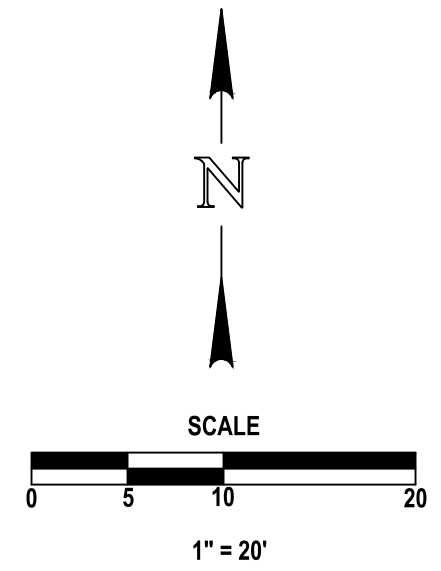

C:\USERS\JOHN\ONEDRIVE - WASHINGTON COUNTY OPS ENGINEERING PROJECTS - DOCUMENTS\PROJECT DEVELOPMENT\100821 - SCHMELTZER RD CULVERT REPLACEMENT PROJECT\DESIGN\PLANS\SCHMELTZER-BASE11425.DWG 12/2/2025 3:16 PM john

NOTES

1. ALL SIGNS SHALL MEET OR EXCEED M.U.T.C.D. PART VI AND COUNTY SPECIFICATIONS.
2. AGENCY WILL POST THE ADVANCE WARNING SIGNS (TYPE 1) A MINIMUM OF 7 DAYS PRIOR TO THE ROAD CLOSURE.
3. PLACE (6) TYPE III BARRICADES:
 - (2) ON THE NORTH SIDE OF THE NIELL ROAD INTERSECTION WITH SIGN TYPE 3
 - (2) ON THE SOUTH SIDE OF THE MOUNTAIN HOME INTERSECTION WITH SIGN TYPE 3
 - (1) ON THE NORTH SIDE OF THE WORK AREA WITH SIGN TYPE 2
 - (1) ON THE SOUTH SIDE OF THE WORK AREA WITH SIGN TYPE 2
4. ALL TYPE III BARRICADES SHALL HAVE TWO OPERATIONAL AMBER FLASHING LIGHTS ATTACHED TO THE TOP OF EACH BARRICADE. SIGN TYPE 5 SHALL BE MOUNTED ON THE TYPE III BARRICADES.
5. ALL SIGNS EXCEPT TYPE 2 & 3 SHALL BE POST MOUNTED PER SPEC SECTION 00225.11(b).
6. NOTIFICATION TO RESIDENTS, SCHOOLS, POSTAL SERVICES, AND EMERGENCY, AND OTHER SERVICE PROVIDERS TO BE PERFORMED BY WASHINGTON COUNTY.
7. MODIFICATIONS TO THE TYPE, QUANTITY, OR LOCATION OF SIGNS MAY BE REQUIRED AS CONDITIONS MANDATE.
8. CONCRETE OR WATER FILLED BARRIERS SHALL BE PLACED ACROSS THE ROAD AT THE END OF EACH WORK DAY ON BOTH SIDES OF ANY OPEN TRENCHES. THERE MUST BE A SUFFICIENT NUMBER OF BARRICADES TO BLOCK ACCESS TO ALL MOTOR VEHICLES.
9. SIGN LOCATIONS ARE FOR GRAPHICAL PURPOSES ONLY. ACTUAL LOCATIONS SHOULD BE FIELD ADJUSTED TO ACCOUNT FOR SIGHT DISTANCES, FIXED OBJECT OBSTRUCTIONS, UTILITIES, ETC. SUBSTANTIAL DEVIATION FROM THIS PLAN REQUIRES COUNTY APPROVAL.
10. ALL SIGNS TO BE PLACED ON THEIR OWN POSTS IN THE GROUND OR ON TEMPORARY SIGN SUPPORTS (TSS) PER ODOT DETAIL TM 821 & TM 822. MOUNTING ON EXISTING SIGN POSTS IS NOT PERMITTED.

1

SCHMELTZER ROAD
CLOSED
NEILL TO MOUNTAINHOME
XX-XX-XX TO XX-XX-XX
USE ALT ROUTE

48"x36" BLACK ON ORANGE

WWW.WC-ROADS.COM

(503) 846-7623

(RIDERS)
36"x6" BLACK ON ORANGE

2

ROAD
CLOSED

(R11-2)

48"x30" BLACK ON WHITE

3

ROAD CLOSED
TO THRU TRAFFIC
LOCAL TRAFFIC ONLY

48"x36" BLACK ON WHITE

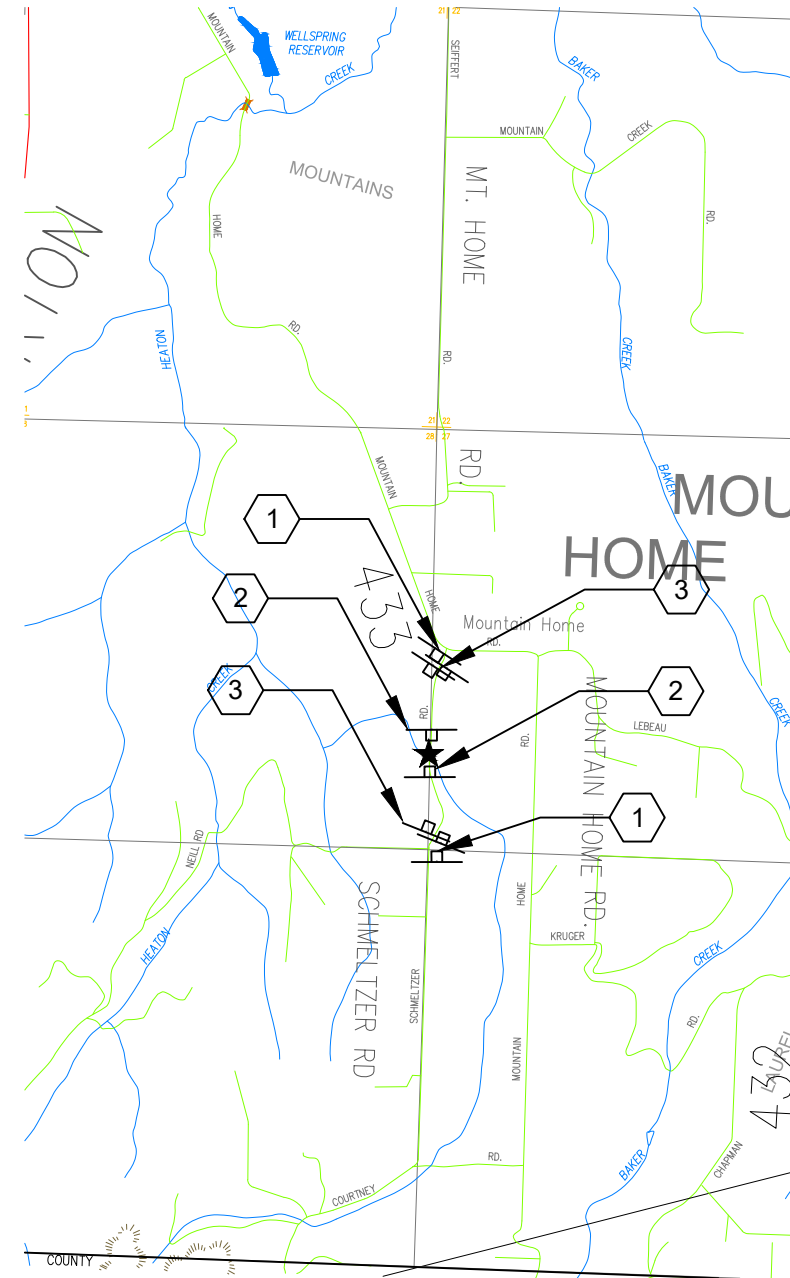

PLAN

NOT TO SCALE

PRELIMINARY

REGISTERED PROFESSIONAL
ENGINEER
59880PE
JAN. 14, 2003
JOHN DYER JENSEN

RENEWAL DATE: 6/30/27

 WASHINGTON COUNTY OREGON	
DEPARTMENT OF LAND USE & TRANSPORTATION OPERATIONS	
DESIGNED BY: J JENSEN DRAWN BY: J JENSEN CHECKED BY: A CLODFELTER	NO. REVISIONS
SCHMELTZER ROAD CULVERT #2309 WASHINGTON COUNTY	
TRAFFIC CONTROL PLAN	
PROJECT NUMBER 100821	
SHEET NO. 4 OF 7 TC01	

C:\USERS\JOHN\ONEDRIVE - WASHINGTON COUNTY OPS ENGINEERING PROJECTS - DOCUMENTS\PROJECT DEVELOPMENT\100821 - SCHMELTZER RD CULVERT REPLACEMENT PROJECT\DESIGN\PLANS\SCHMELTZER-BASE11425.DWG 12/2/2025 9:14 AM .dgn

CONSTRUCTION NOTES:

- ① FULL WIDTH GRAVEL LIMITS STA 11+79 TO STA 12+49
- ② REMOVE EXISTING CULVERT, 54" DIA. CMP, 55 LF
- ③ INSTALL 12'X6' CONCRETE BOX CULVERT, 66LF. SEE SHEET C02 FOR PLAN AND PROFILE.
- ④ INSTALL CULVERT DRAINAGE MARKER TYPE 2 (SEE WASH. CO. STD. DWG 6598 AND ODOT STD. DWG TM570).

FILE 01
NO SITE ADDRESS
TL 2S2280001300

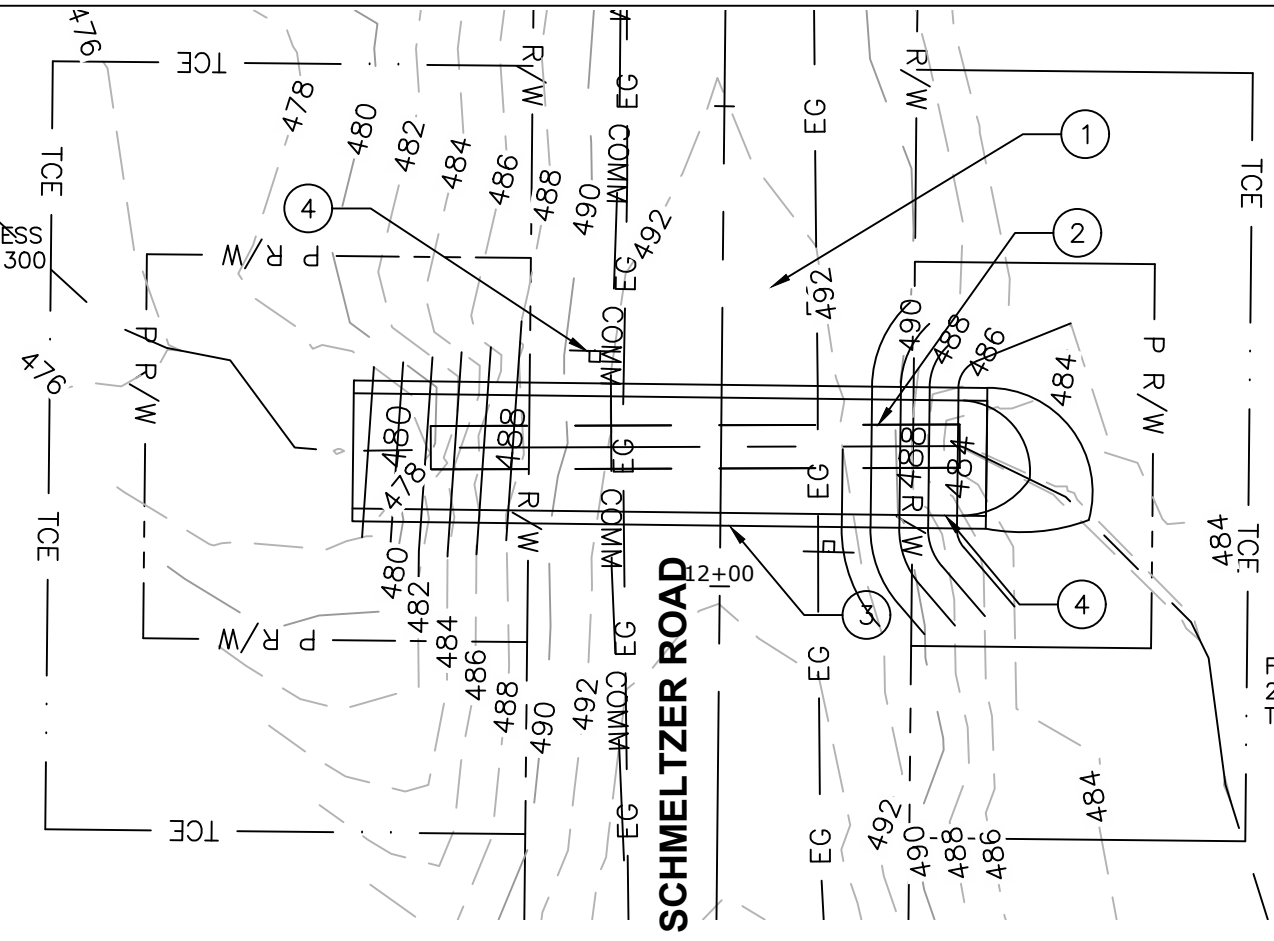

FILE 02
21430 SW SCHMELTZER RD.
TL 2S2270000702

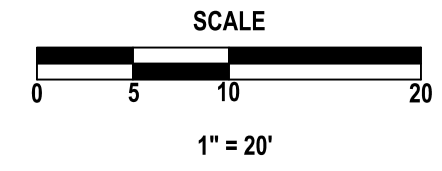

REGISTERED PROFESSIONAL ENGINEER
59880PE

PRELIMINARY

JAN. 14, 2023
JOHN DYER JENSEN

RENEWAL DATE: 6/30/27

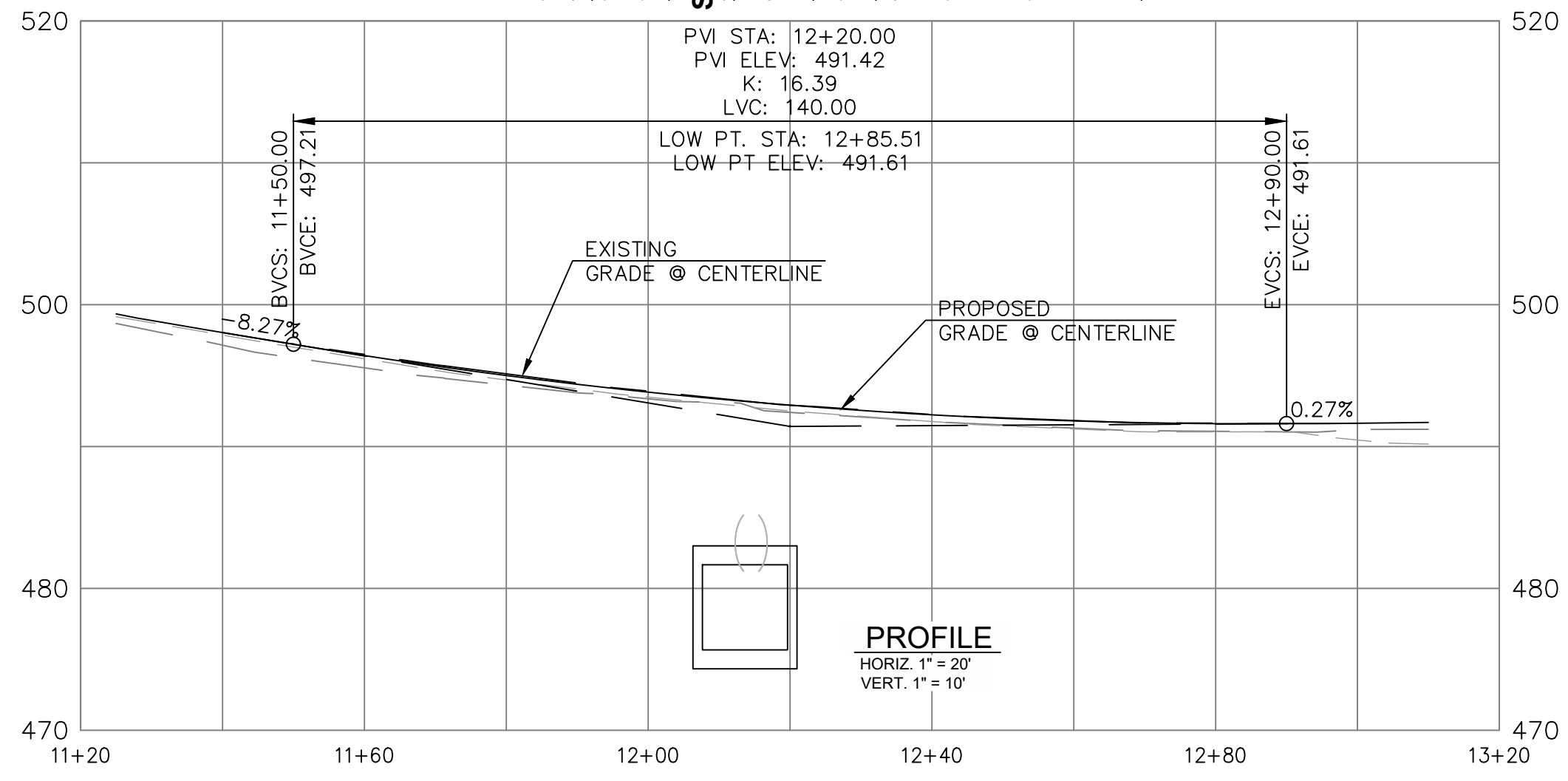

DEPARTMENT OF
LAND USE &
TRANSPORTATION
OPERATIONS

DESIGNED BY: J JENSEN	
DRAWN BY: J JENSEN	
CHECKED BY: A CLODFELTER	
NO. REVISIONS	

SCHMELTZER ROAD
CULVERT #2309
WASHINGTON COUNTY

GRADING AND EROSION CONTROL PLAN

PROJECT NUMBER
100821

SHEET NO.
5 OF **7**
EC01

C:\USERS\JOHN\ONEDRIVE - WASHINGTON COUNTY OPS ENGINEERING PROJECTS - DOCUMENTS\PROJECT DEVELOPMENT\100821 - SCHMELTZER RD CULVERT REPLACEMENT PROJECT DESIGN\PLANS\SCHMELTZER-BASET11425.DWG 12/2/2025 9:17 AM .dgn

CONSTRUCTION NOTES:

1. GRANULAR STRUCTURAL BACKFILL MATERIAL TO BE PLACED IN A MAXIMUM OF 6" LIFTS.
2. PLACE A CONTINUOUS FLEXIBLE WATERTIGHT SEAL IN THE JOINT, ON THE SIDES AND TOP, BETWEEN EACH PRECAST CULVERT SECTION.
3. REFER TO ODOT'S 2024 OREGON STANDARD SPECIFICATIONS FOR CONSTRUCTION FOR ADDITIONAL INSTALLATION AND BACKFILL GUIDELINES.
4. EXCAVATION BEYOND LIMITS SHOWN SUBJECT OF APPROVAL BY THE ENGINEER. TRENCH SIDE SLOPE REQUIREMENTS SUBJECT TO ADJUSTMENT BY THE ENGINEER BASED ON FIELD CONDITIONS.
5. RESTORE DISTURBED CHANNEL CROSS SECTIONS TO MATCH UNDISTURBED SECTION. RESTORE STREAMBED TO ITS FORMER CONDITION OF RESISTANCE TO SCOUR. REMOVE ALL MATTER THAT HAS COME INTO THE STREAM DUE TO CONTRACTOR'S ACTIVITIES.

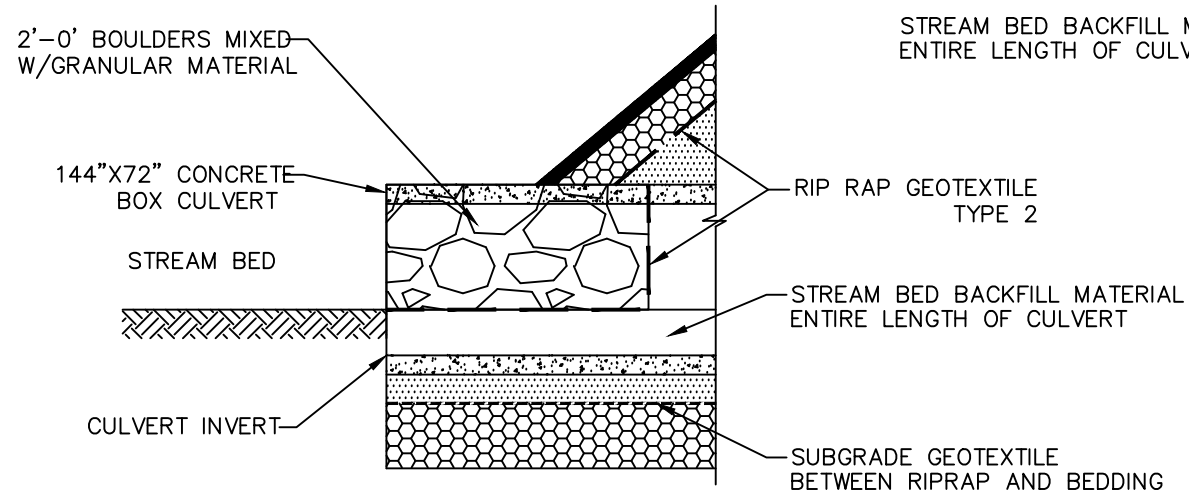

BOULDERS AT UPSTREAM AND DOWNSTREAM CULVERT ENDS

N.T.S.

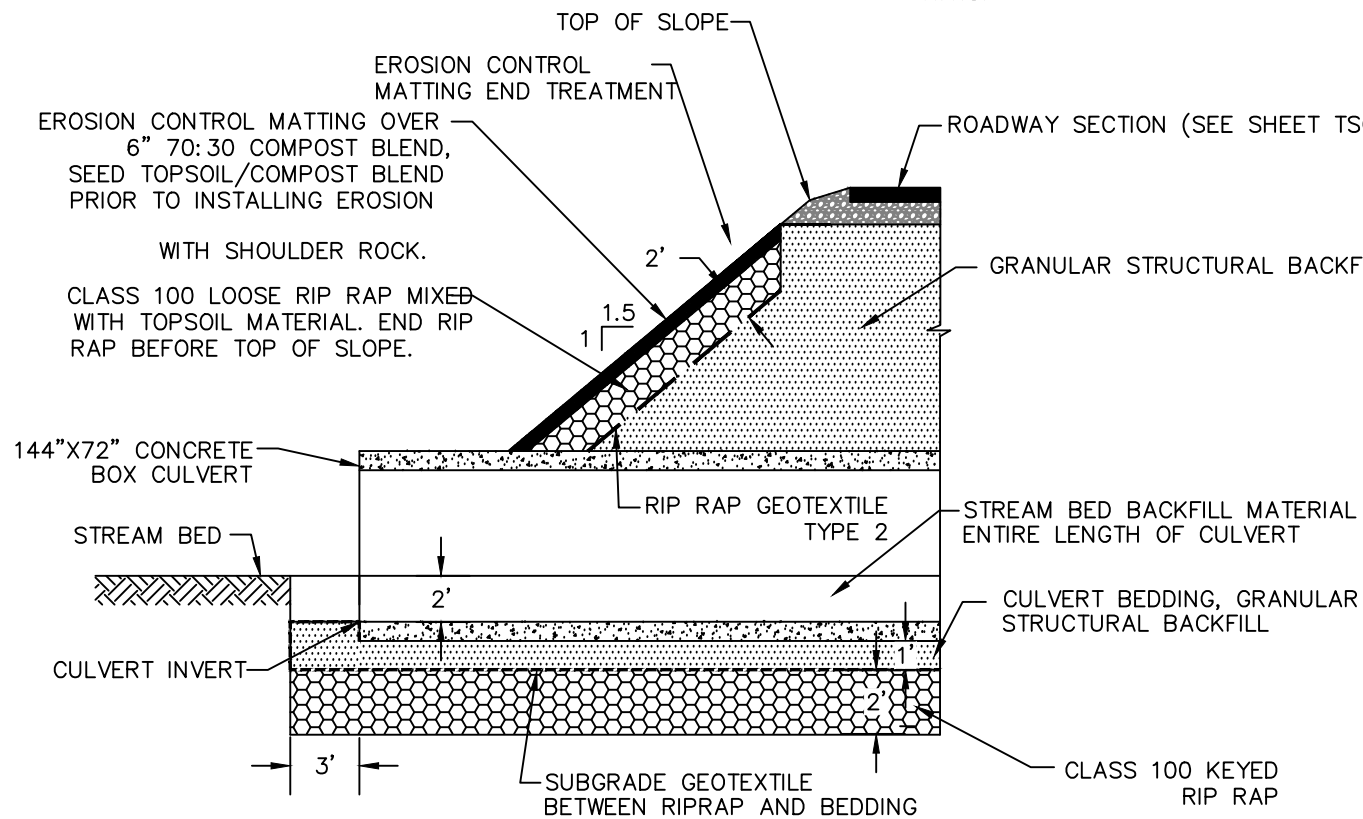

DOWNSTREAM CULVERT END

N.T.S.

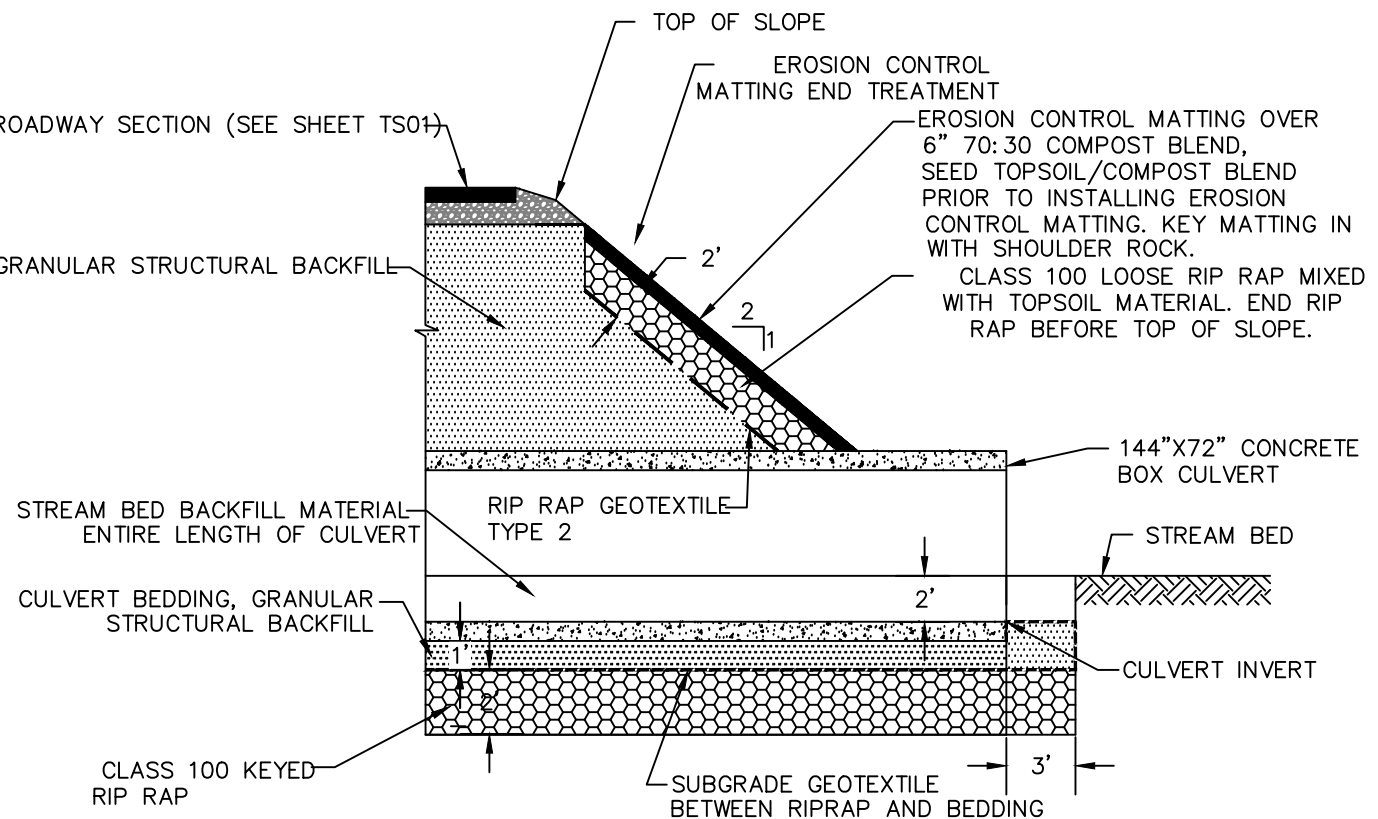

UPSTREAM CULVERT END

N.T.S.

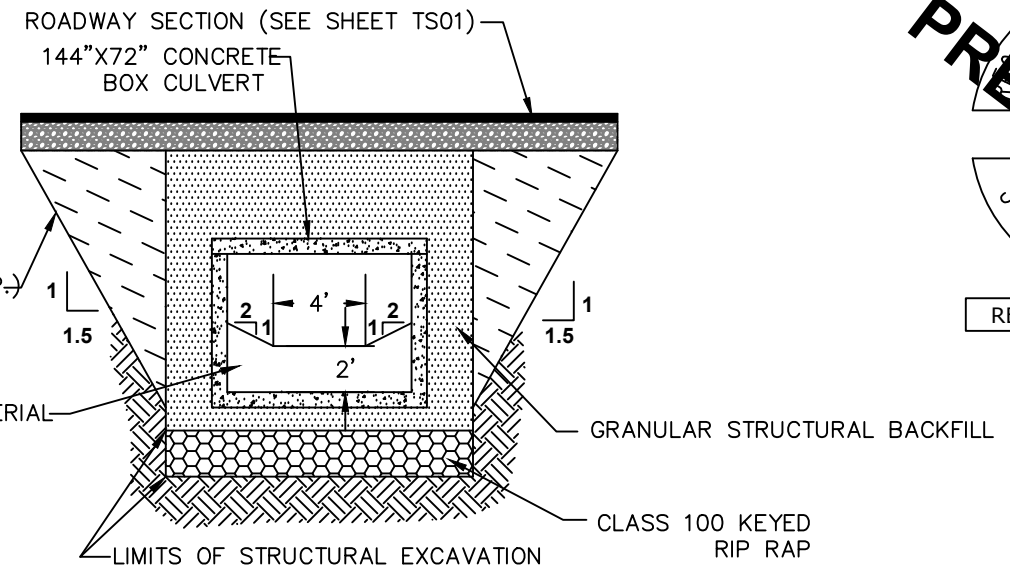

CULVERT SECTION

N.T.S.

NATIVE OR REJECT MATERIAL MAY BE USED AS BACKFILL OUTSIDE OF TRENCH BACKFILL LIMITS. SEE PROJECT SPECIFICATIONS FOR MATERIAL TESTING AND COMPACTION REQUIREMENTS.

REGISTERED PROFESSIONAL ENGINEER
59880PE
PRELIMINARY
JAN. 14, 2023
JOHN DYER JENSEN
RENEWAL DATE: 6/30/27

DEPARTMENT OF
LAND USE &
TRANSPORTATION
OPERATIONS



DESIGNED BY: J JENSEN
DRAWN BY: J JENSEN
CHECKED BY: A CLODFELTER

NO. REVISIONS

SCHMELTZER ROAD
CULVERT #2309
WASHINGTON COUNTY

DETAILS

PROJECT NUMBER

100821

SHEET NO.
7 OF 7

C03

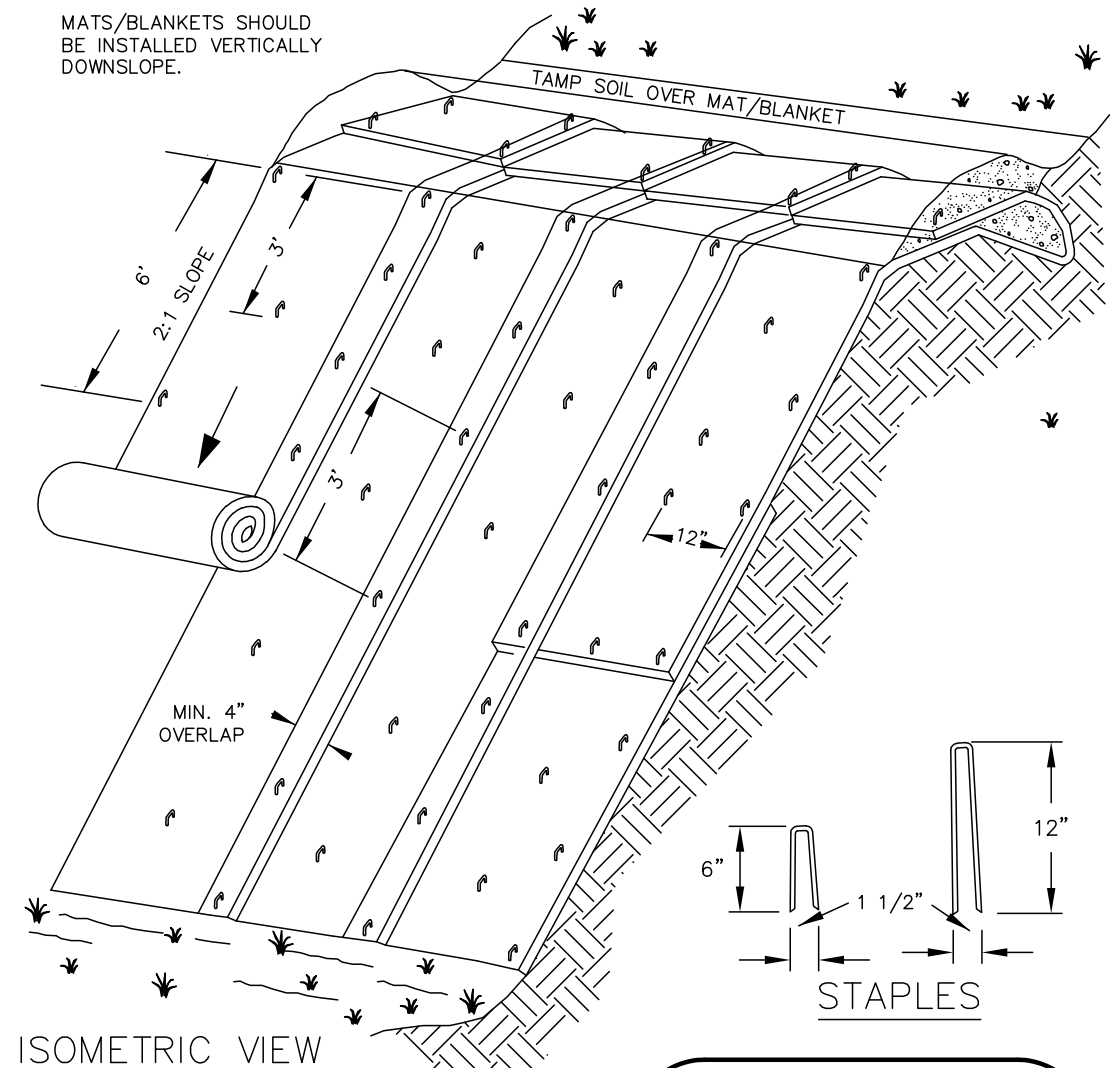

TYPICAL SLOPE SOIL STABILIZATION

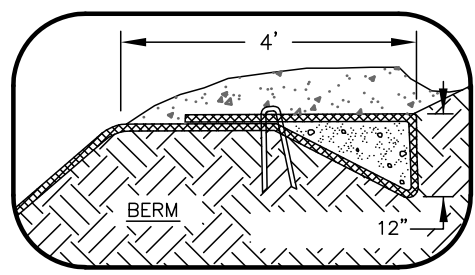

NOT TO SCALE

NOTES:

1. SLOPE SURFACE SHALL BE FREE OF ROCKS, CLOUDS, STICKS AND GRASS. MATS/BANKETS SHALL HAVE GOOD SOIL CONTACT.
2. APPLY PERMANENT SEEDING BEFORE PLACING BANKETS.
3. LAY BANKETS LOOSELY AND STAKE OR STAPLE TO MAINTAIN DIRECT CONTACT WITH THE SOIL. DO NOT STRETCH.
4. STAKING OR STAPLING LAYOUT PER MANUFACTURERS SPECIFICATIONS.

FOR FURTHER INFORMATION ON DESIGN CRITERIA SEE CHAPTER 4 OF CLEAN WATER SERVICES EROSION PREVENTION AND SEDIMENT CONTROL PLANNING AND DESIGN MANUAL.

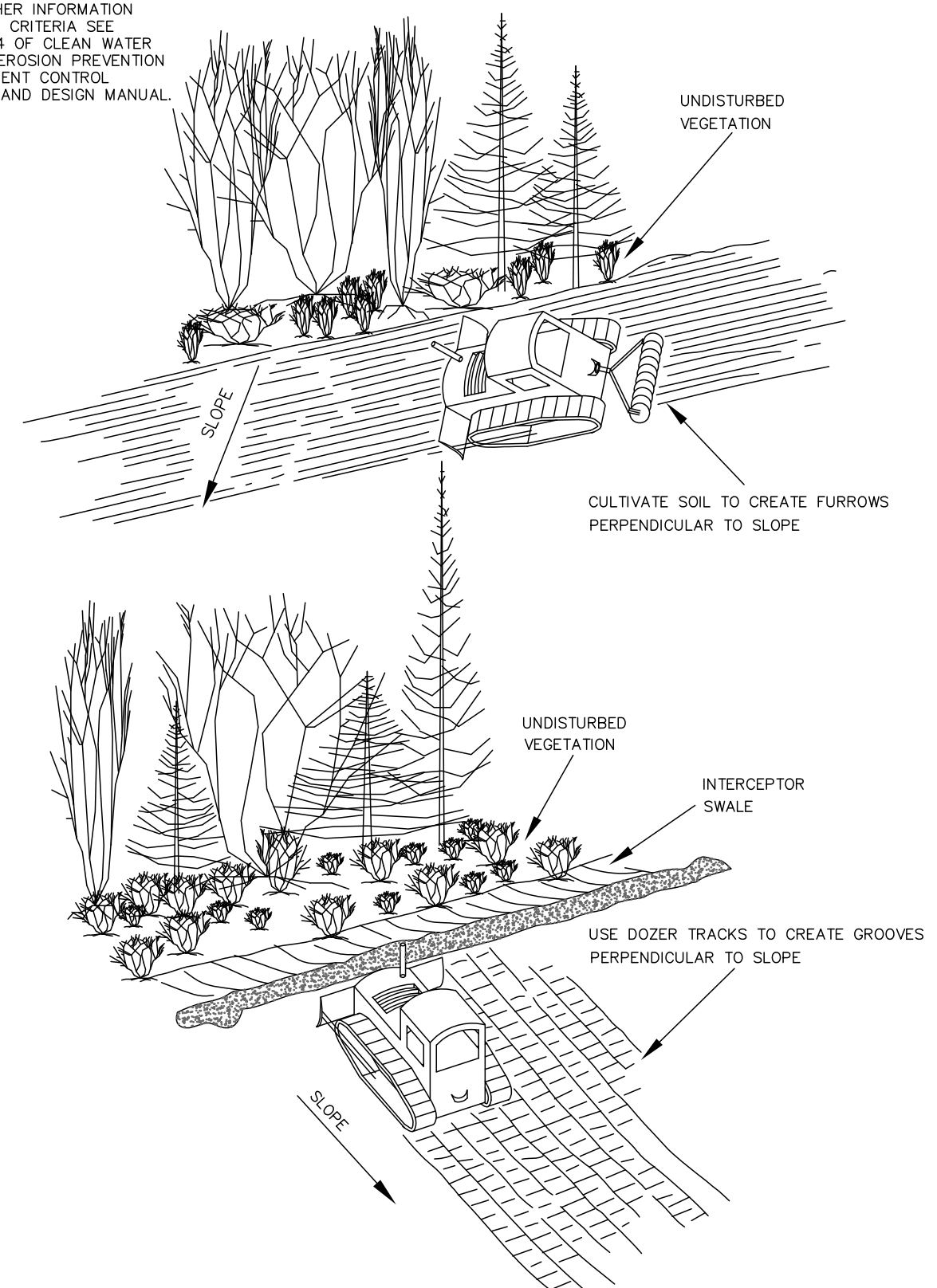

SURFACE ROUGHENING CAT TRACKING

DRAWING NO. 830

REVISED 10-31-19

MATTING SLOPE INSTALLATION



DRAWING NO. 805

REVISED 10-31-19

FOR FURTHER INFORMATION
ON DESIGN CRITERIA SEE
CHAPTER 4 OF CLEAN WATER
SERVICES EROSION PREVENTION
AND SEDIMENT CONTROL
PLANNING AND DESIGN MANUAL.

STAIR STEPPING CUT SLOPES

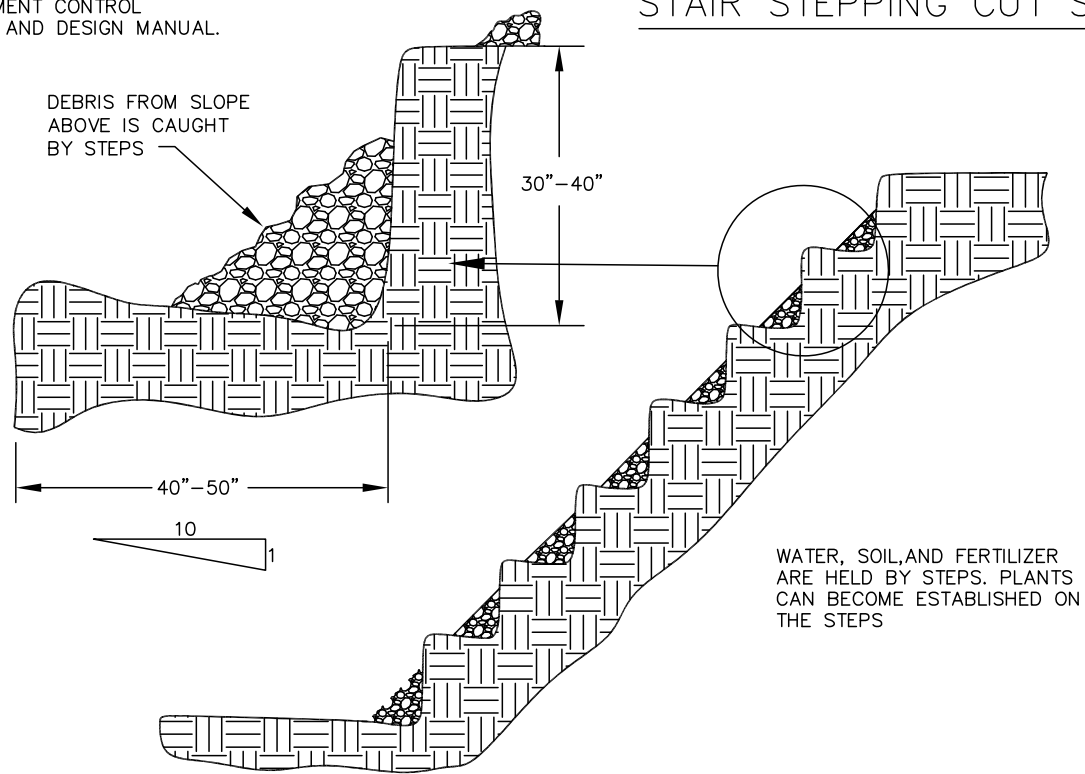

GROOVING SLOPES

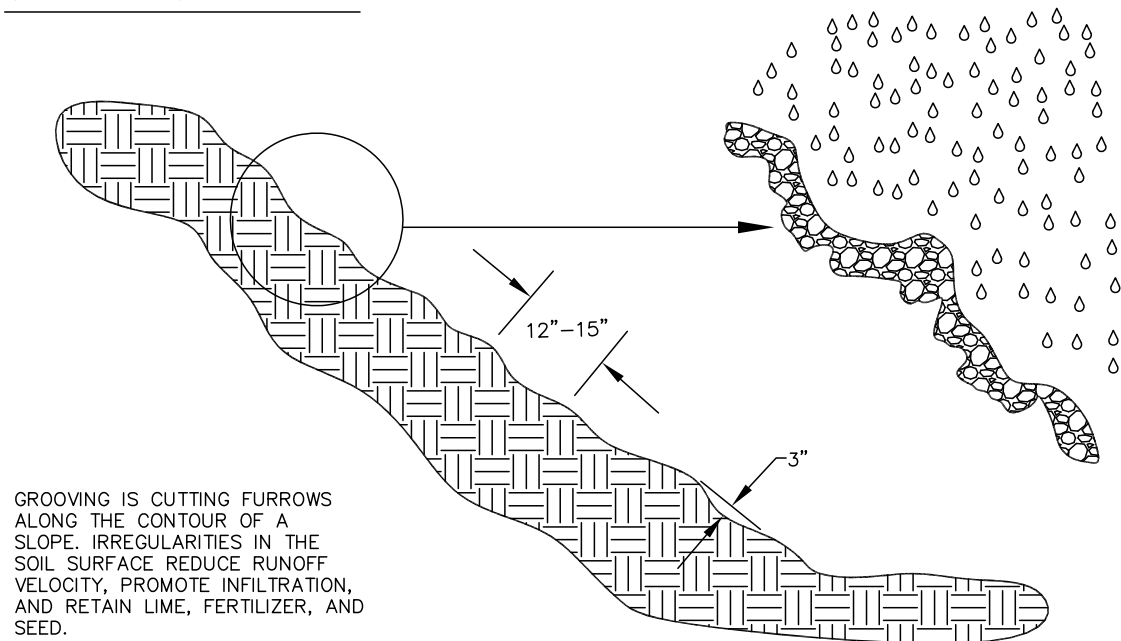

SURFACE ROUGHENING STAIR STEPPING/GROOVING SLOPES

DRAWING NO. 835

REVISED 10-31-19

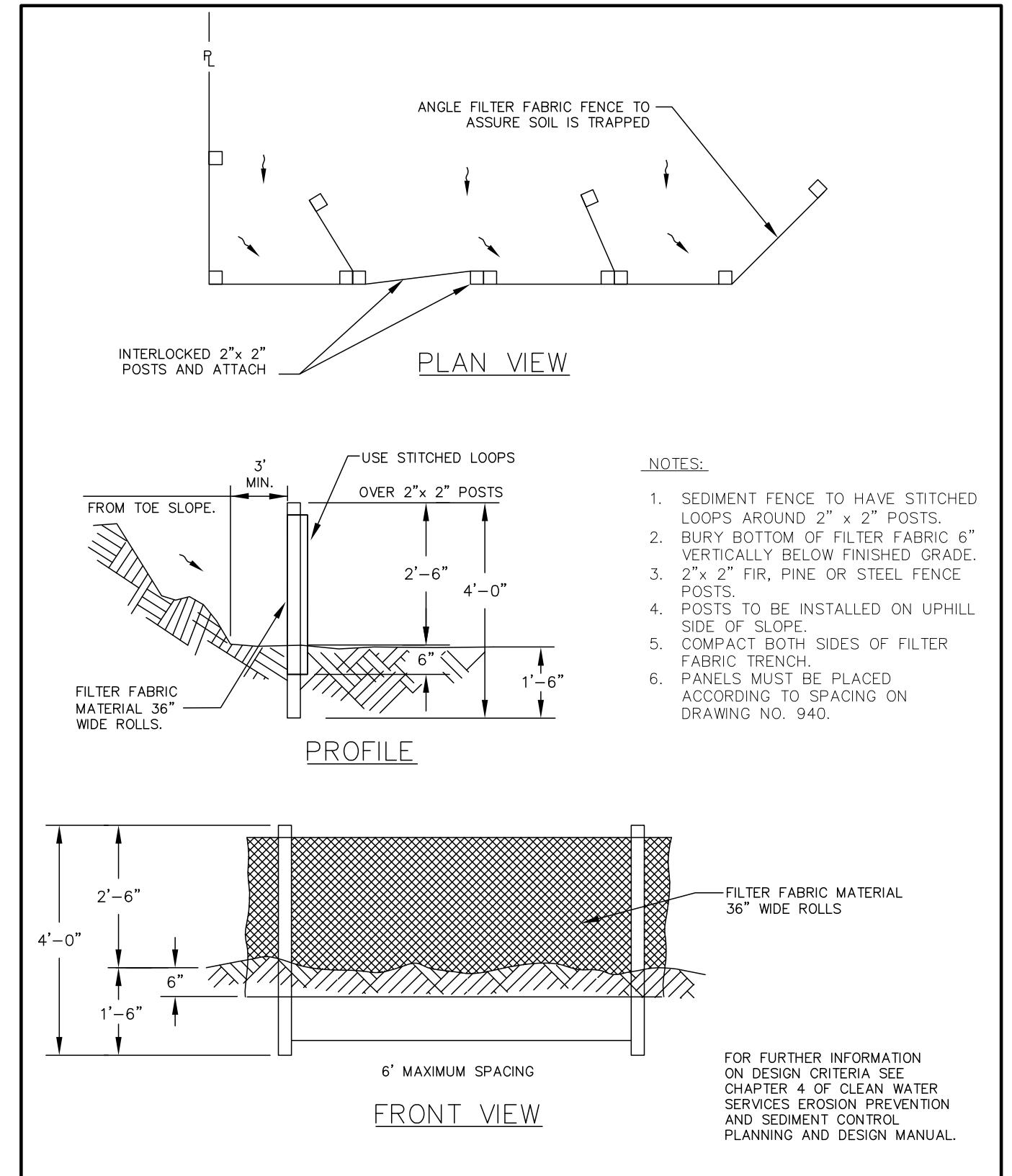

SEDIMENT FENCE

DRAWING NO. 875

REVISED 10-31-19



FOR FURTHER INFORMATION
ON DESIGN CRITERIA SEE
CHAPTER 4 OF CLEAN WATER
SERVICES EROSION PREVENTION
AND SEDIMENT CONTROL
PLANNING AND DESIGN MANUAL.

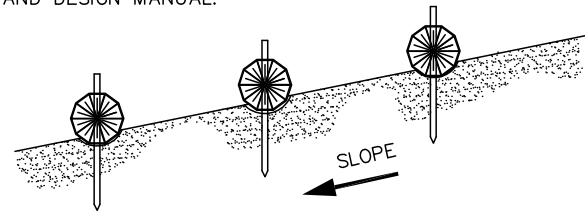

PROFILE

WHEAT STRAW, RYE
GRASS STRAW,
COCONUT OR
EXCELSIOR WATTLES

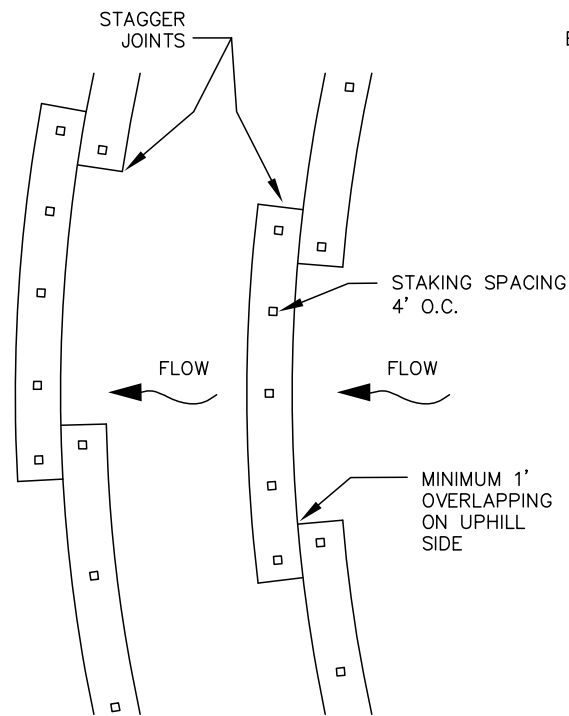

PLAN VIEW

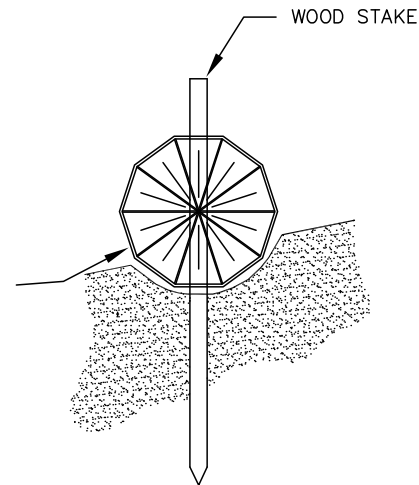

SECTION

NOTES:

1. STAKING SPECIFICATIONS:
 - a. 1"X2" WOODEN STAKES
 - b. ADDITIONAL STAKES MAY BE INSTALLED ON DOWNHILL SIDE OF WATTLES, ON STEEP SLOPE OR HIGHLY EROSION SOILS.
2. SPACING IN ACCORDANCE WITH DETAIL 940.
3. REMOVE ALL ROCKS, CLODS, VEGETATION OR OTHER OBSTRUCTIONS SO THAT THE INSTALLED WATTLES WILL HAVE DIRECT CONTACT WITH THE SOIL.
4. INSTALL THE WATTLES IN A 2" DEEP TRENCH, INSURING THAT NO GAPS EXIST BETWEEN THE SOIL AND THE BOTTOM OF THE WATTLE. THE ENDS OF ADJACENT WATTLES SHALL BE OVERLAPPED 1 FT. MINIMUM TO PREVENT SEDIMENT PASSING THROUGH THE FIELD JOINT.

NOTES:

1. WHEN RAINFALL AND RUNOFF OCCURS, A KNOWLEDGEABLE AND EXPERIENCED PERSON IN THE PRINCIPLES, PRACTICES, INSTALLATION, AND MAINTENANCE OF EROSION AND SEDIMENT CONTROLS WHO WORKS FOR THE PERMITTEE MUST PROVIDE DAILY INSPECTIONS OF THE EROSION AND SEDIMENT CONTROLS AND DISCHARGE OUTFALLS.
2. CONSTRUCTION ACTIVITIES MUST AVOID OR MINIMIZE EXCAVATION AND CREATION OF BARE GROUND FROM OCTOBER 1 THROUGH MAY 31ST EACH YEAR.
3. DURING WET WEATHER PERIOD, TEMPORARY STABILIZATION OF THE SITE MUST OCCUR AT THE END OF EACH WORK DAY.
4. SEDIMENT CONTROLS MUST BE INSTALLED AND MAINTAINED ON ALL DOWN GRADIENT SIDES OF THE CONSTRUCTION SITE AT ALL TIMES DURING CONSTRUCTION. THEY MUST REMAIN IN PLACE UNTIL PERMANENT VEGETATION OR OTHER PERMANENT COVERING OF EXPOSED SOIL IS ESTABLISHED.
5. ALL ACTIVE INLETS MUST HAVE SEDIMENT CONTROLS INSTALLED AND MAINTAINED AT ALL TIMES DURING CONSTRUCTION.
6. SIGNIFICANT AMOUNTS OF SEDIMENT THAT LEAVES THE SITE MUST BE CLEANED UP WITHIN 24 HOURS AND PLACED BACK ON THE SITE AND STABILIZED OR PROPERLY DISPOSED. THE CAUSE OF THE SEDIMENT RELEASE MUST BE FOUND AND PREVENTED FROM CAUSING A RECURRENCE OF THE DISCHARGE WITHIN THE SAME 24 HOURS. ANY IN-STREAM CLEAN UP OF SEDIMENT SHALL BE PERFORMED ACCORDING TO THE OREGON DEPARTMENT OF STATE LANDS REQUIRED TIME FRAME.
7. SEDIMENT MUST NOT BE INTENTIONALLY WASHED INTO STORM SEWERS, DRAINAGE WAYS, OR WATER BODIES.
8. SEDIMENT MUST BE REMOVED FROM BEHIND ALL SEDIMENT CONTROL MEASURES WHEN IT HAS REACHED A HEIGHT OF 1/3-RD THE BARRIER HEIGHT AND PRIOR TO THE CONTROL MEASURES REMOVAL.
9. CLEANING OF ALL STRUCTURES WITH SUMPS MUST OCCUR WHEN THE SEDIMENT RETENTION CAPACITY HAS BEEN REDUCED BY 50% AND AT COMPLETION OF PROJECT.
10. ANY USE OF TOXIC OR OTHER HAZARDOUS MATERIALS MUST INCLUDE PROPER STORAGE, APPLICATION, AND DISPOSAL.
11. THE PERMITTEE MUST PROPERLY MANAGE HAZARDOUS WASTES, USED OILS, CONTAMINATED SOILS, CONCRETE WASTE, SANITARY WASTE, LIQUID WASTE, OR OTHER TOXIC SUBSTANCES DISCOVERED OR GENERATED DURING CONSTRUCTION.
12. THE APPLICATION RATE OF FERTILIZERS USED TO REESTABLISH VEGETATION MUST FOLLOW MANUFACTURER'S RECOMMENDATIONS. NUTRIENT RELEASES FROM FERTILIZERS TO SURFACE WATERS MUST BE MINIMIZED. TIME RELEASE FERTILIZERS SHOULD BE USED AND CARE SHOULD BE MADE IN APPLICATION OF FERTILIZERS WITHIN ANY WATER WAY RIPARIAN ZONE.
13. OWNER OR DESIGNATED PERSON SHALL BE RESPONSIBLE FOR PROPER INSTALLATION AND MAINTENANCE OF ALL EROSION AND SEDIMENT CONTROL MEASURES, IN ACCORDANCE WITH CURRENT CLEAN WATER SERVICES STANDARDS AND STATE, AND FEDERAL REGULATIONS.
14. PRIOR TO ANY LAND DISTURBING ACTIVITIES, THE BOUNDARIES OF THE CLEARING LIMITS, VEGETATED BUFFERS, AND ANY SENSITIVE AREAS SHOWN ON THIS PLAN SHALL BE CLEARLY DELINEATED IN THE FIELD. UNLESS OTHERWISE APPROVED, NO DISTURBANCE IS PERMITTED BEYOND THE CLEARING LIMITS. THE OWNER/PERMITTEE MUST MAINTAIN THE DELINEATION FOR THE DURATION OF THE PROJECT. NOTE: VEGETATED CORRIDORS TO BE DELINEATED WITH ORANGE CONSTRUCTION FENCE OR APPROVED EQUAL.
15. PRIOR TO ANY LAND DISTURBING ACTIVITIES, THE BMPs THAT MUST BE INSTALLED ARE GRAVEL CONSTRUCTION ENTRANCE, PERIMETER SEDIMENT CONTROL, AND INLET PROTECTION. THESE BMPs MUST BE MAINTAINED FOR THE DURATION OF THE PROJECT.
16. IF VEGETATIVE SEED MIXES ARE SPECIFIED, SEEDING MUST TAKE PLACE NO LATER THAN SEPTEMBER 1ST; THE TYPE AND PERCENTAGES OF SEED IN THE MIX ARE AS IDENTIFIED ON THE PLANS OR AS SPECIFIED BY THE DESIGN ENGINEER.
17. WATERTIGHT TRUCKS MUST BE USED TO TRANSPORT SATURATED SOILS FROM THE CONSTRUCTION SITE. AN APPROVED EQUIVALENT IS TO DRAIN THE SOIL ON SITE AT A DESIGNATED LOCATION USING APPROPRIATE BMPs; SOIL MUST BE DRAINED SUFFICIENTLY FOR MINIMAL SPILLAGE.
18. ALL PUMPING OF SEDIMENT LADEN WATER MUST BE DISCHARGED OVER AN UNDISTURBED, PREFERABLY VEGETATED AREA, AND THROUGH A SEDIMENT CONTROL BMP (I.E. FILTER BAG).
19. THE ESC PLAN MUST BE KEPT ONSITE. ALL MEASURES SHOWN ON THE PLAN MUST BE INSTALLED PROPERLY TO ENSURE THAT SEDIMENT LADEN WATER DOES NOT ENTER A SURFACE WATER SYSTEM, ROADWAY, OR OTHER PROPERTIES.
20. THE ESC MEASURES SHOWN ON THIS PLAN ARE THE MINIMUM REQUIREMENTS FOR ANTICIPATED SITE CONDITIONS. DURING THE CONSTRUCTION PERIOD, THESE MEASURES SHALL BE UPGRADED AS NEEDED TO MAINTAIN COMPLIANCE WITH ALL REGULATIONS.
21. WRITTEN ESC LOGS ARE SUGGESTED TO BE MAINTAINED ONSITE AND AVAILABLE TO DISTRICT INSPECTORS UPON REQUEST.
22. IN AREAS SUBJECT TO WIND EROSION, APPROPRIATE BMPs MUST BE USED, WHICH MAY INCLUDE THE APPLICATION OF FINE WATER SPRAYING, PLASTIC SHEETING, MULCHING, OR OTHER APPROVED MEASURES.
23. ALL EXPOSED SOILS MUST BE COVERED, AT END OF BUSINESS DAY, DURING WET WEATHER PERIOD, FROM OCTOBER 1 - MAY 31.

WATTLES



DRAWING NO. 880

REVISED 10-31-19

STANDARD EROSION CONTROL
NOTES FOR SITES LESS THAN 1
ACRE

DRAWING NO. 945

REVISED 10-31-19



TABLE A

"A" (in)	"B" (in)	"C" (in)	"D" (in)
4	10	4	8
6	10	4	8
8	10	6	10
10	10	6	10
12	12	6	10
15	12	6	10
18	16	6	12
21	16	6	12
24	18	6	12
30	18	6	12
36	24	6	14
42	24	6	14
48	24	6	14
54	24	6	14
60	24	6	14
66	24	6	14
72	24	6	14

For pipes over 72" diameter,
see general note 3.

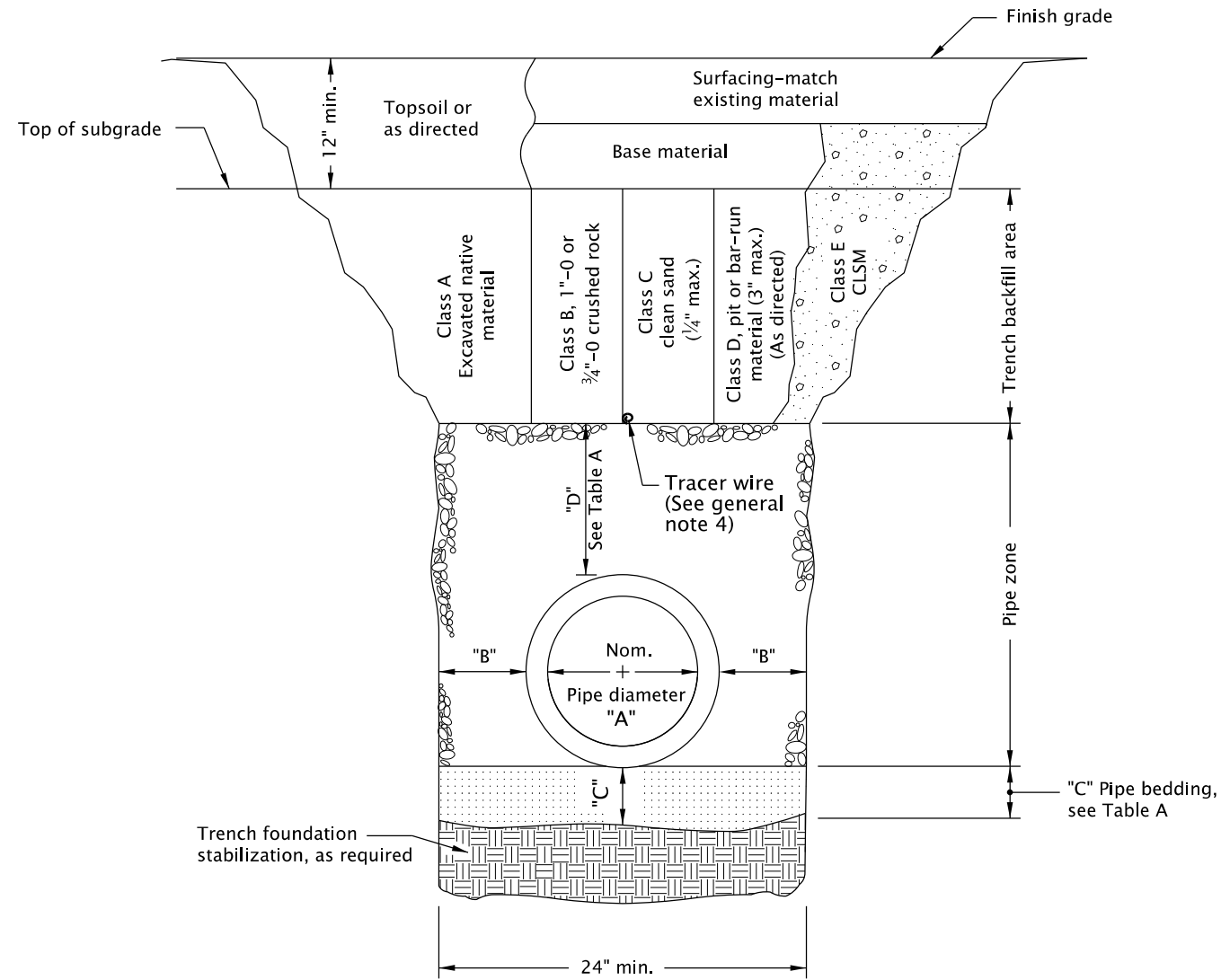

MULTIPLE INSTALLATIONS	
DIAMETER	MIN. SPACE BETWEEN PIPES
Up to 48"	24"
48" to 72"	One half (1/2) dia. of pipe

GENERAL NOTES FOR ALL DETAILS ON THIS SHEET:

1. Surfacing of paved areas shall comply with street cut Std. Dwg. RD302.
2. For pipe installation in embankment areas where the trench method will not be used and the pipe is ≥ 36 " diameter, increase dimension "B" to nominal pipe diameter.
3. Pipes over 72" diameter are structures, and are not applicable to this drawing.
4. See Std. Dwg. RD336 for tracer wire details (When required).

The selection and use of this Standard Drawing, while designed in accordance with generally accepted engineering principles and practices, is the sole responsibility of the user and should not be used without first consulting a Registered Professional Engineer.

All materials shall be in accordance with the current Oregon Standard Specifications.

OREGON STANDARD DRAWINGS
TRENCH BACKFILL, BEDDING,
PIPE ZONE AND MULTIPLE
INSTALLATIONS

2024

DATE	REVISION	DESCRIPTION
CALC. BOOK NO. --- N/A ---	SDR DATE-- 14-JUL-2014	RD300

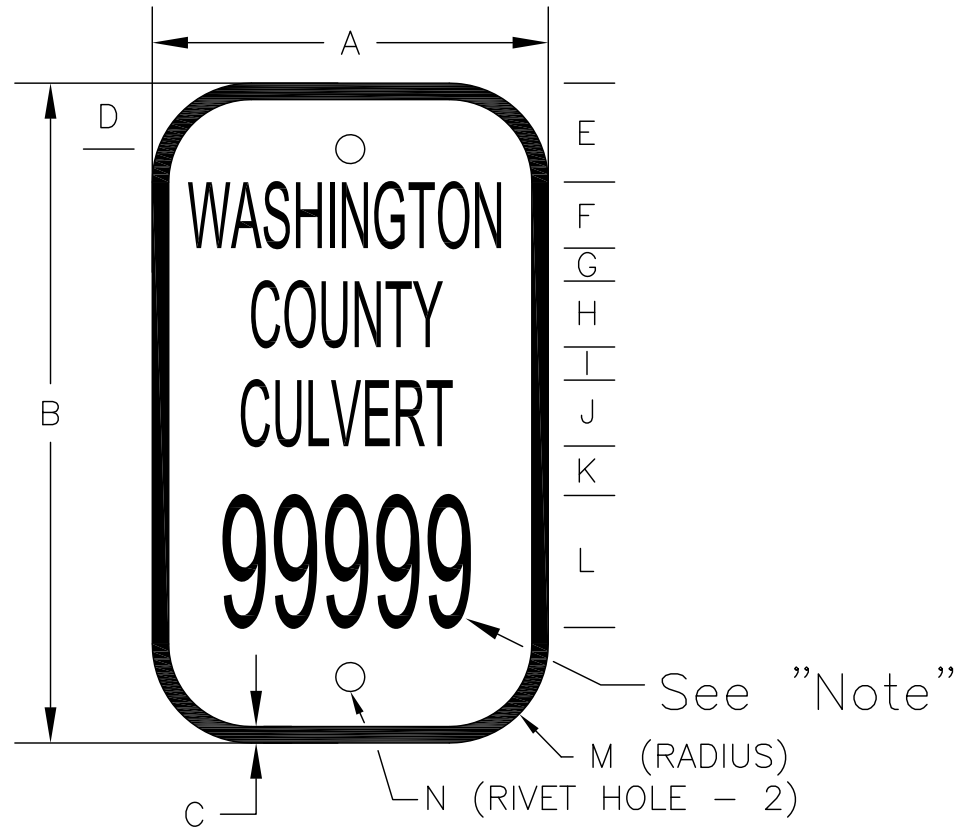

Sign Background: Green, Retro-Reflective Sheeting
Sign Legend: White, Retro-Reflective
Note: Obtain culvert number from Engineer

DIMENSIONS (INCHES)

A	B	C	D	E	F	G	H	I	J	K	L	M	N
6	10	$\frac{1}{4}$	1	1.5	1	$\frac{1}{2}$	1	$\frac{1}{2}$	1	$\frac{1}{2}$	2	1.5	$\frac{7}{16}$

The CULVERT NUMBER sign shall be installed on a sign post on the shoulder of the roadway near the center of the culvert crossing. Signs shall be installed for each travel direction. The CULVERT NUMBER sign may be installed on a guardrail post or sign post with another sign.



WASHINGTON COUNTY
 DEPARTMENT OF LAND USE &
 TRANSPORTATION
 ENGINEERING SECTION

CULVERT NUMBER SIGN

PLOT STAMP: 08/17/15 3:04P KELLYE
 CAD: 6598.DWG

EFFECTIVE DATE:

8/12/2015

WASH. CO. #

6598